



Effective - 12/31/2024
 ~Prices Subject to Change~



Stand Alone
 Condos (Smart Ct.)
 Ask for more
 information!

**- The Glen at Standing Stone -
 - Waukesha, WI -**



Building Exceptional Lifestyles, Everyday!

S = Sold	O = Available & Upcoming Ready Homes
Floor Plans & Base Pricing	
Bristol - 1,727sqft.*	\$559,999
Kenzie - 1,863sqft.*	\$569,999
Calli - 1,877sqft.*	\$569,999
Tartan - 2,013sqft.*	\$584,999
Lookout (LO) homes include exposure additions & Azek composite deck	

The Glen at
Standing Stone

● – Available & Upcoming “Ready Homes” – 12/31/2024 –

#	Floor Plan	Exposure	Garage	Price
<u>#1-1</u>	Tartan 9'	Lookout*	2 Car	\$749,999 (Available Now!*) ●
<u>#3-5</u>	Tartan 8'	Lookout*	2 Car	\$789,999 (Available Now!*) ●
<u>#7-14</u>	Tartan 8'	At Grade	2 Car	\$641,313 (January 2025*) ●
<u>#8-15</u>	Any -- 8'	At Grade	2Car	--- TBD
<u>#8-16</u>	Any -- 8'	At Grade	2 Car	--- TBD
<u>#15-31</u>	Any --	At Grade	2 Car	--- TBD
<u>#15-32</u>	Any --	At Grade	2 Car	--- TBD
<u>#15-33</u>	Any --	At Grade	2 Car	--- TBD
<u>#15-34</u>	Any --	At Grade	2 Car	--- TBD
<u>#16-35</u>	Any -- 8'	At Grade	2 Car	\$584,999 (Base Only)
<u>#16-36</u>	Any -- 8'	At Grade	2 Car	\$584,999 (Base Only)
<u>#16-38</u>	Any -- 9'	At Grade	2 Car	\$594,759 (Base Only)
<u>#17-39</u>	Tartan 8'	At Grade	2 Car	\$617,359 (w/Upgrades) ●
<u>#23-61</u>	Tartan 8'	At Grade	2 Car	\$639,423 (February 2025*) ●
<u>#23-64</u>	Tartan 8'	At Grade	2 Car	\$626,867 (February 2025*) ●



(16) Stand Alone
 Condominium Homes



S = SOLD Available & In Progress
 Ready Homes

Home Pricing
 ~Effective 1/2/2025~

Home Plan	Pricing
Holly-	\$649,999
Cypress-	\$659,999
Laurel-	\$669,999
Hawthorne-	\$669,999
Willow-	\$679,999
Juniper-	\$699,999

All homes are a "Lookout" Exposure & include an elevated Azek* composite deck.



Building Exceptional Lifestyles, Everyday!

**(16) Stand Alone
Condominium Homes -**

- #65 – Cypress S
- #66 – All Homes
- #67 – All Homes
- #68 – All Homes
- #69 – Cypress S
- #70 – Juniper S
- #71 – C, L, Haw, W
- #72 – Hawthorne S
- #73 – Laurel (Ready Home) ●
- #74 – Cypress S
- #75 – Cypress S
- #76 – Cypress S
- #77 – Holly (Only) R
- #78 – Holly S
- #79 – Holly (Only)
- #80 – Cypress S

~Updated 1/2/2025~

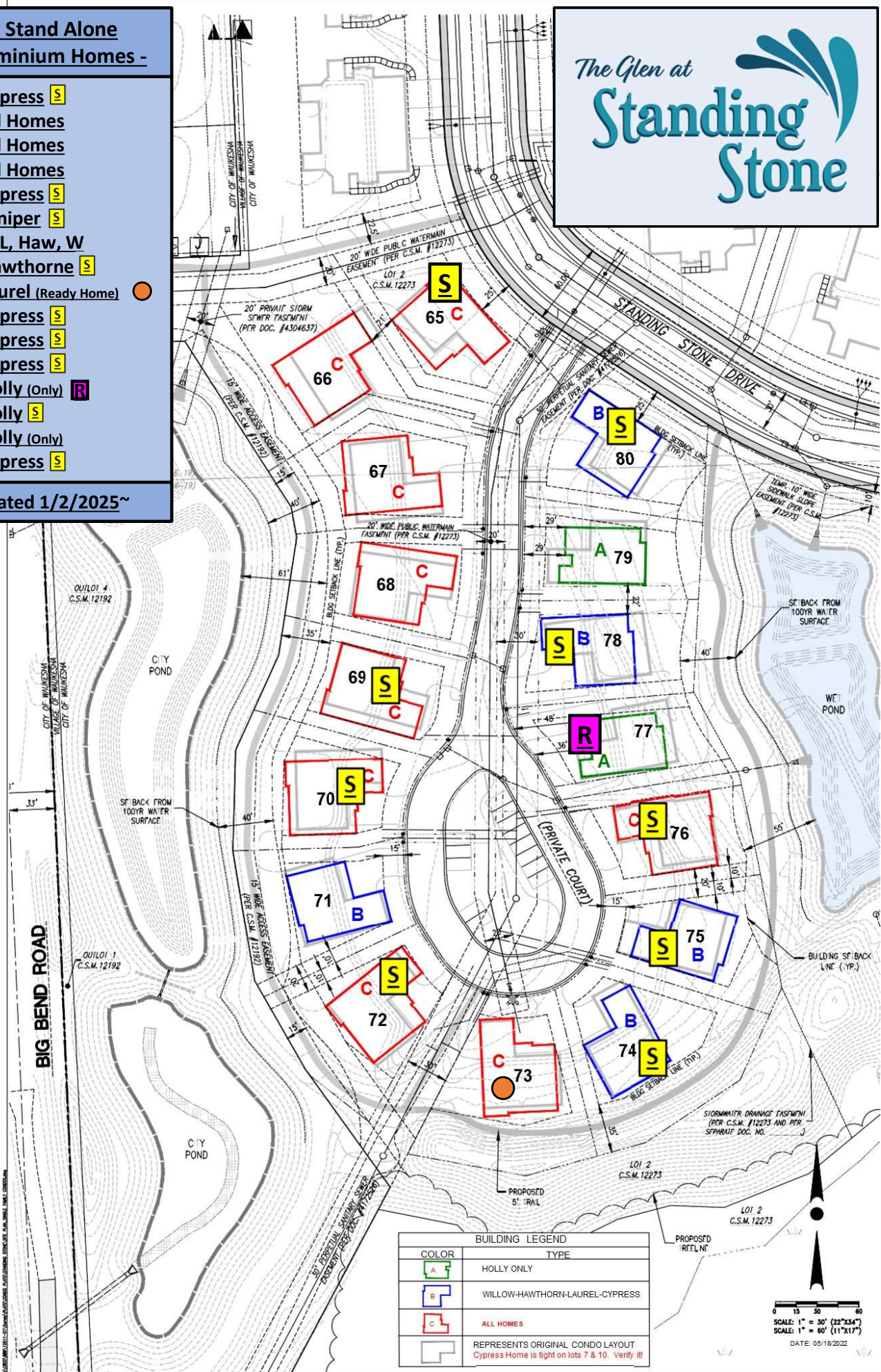

BUILDING LEGEND	
COLOR	TYPE
A	HOLLY ONLY
B	WILLOW-HAWTHORN-LAUREL-CYPRESS
C	ALL HOMES
[Outline]	REPRESENTS ORIGINAL CONDO LAYOUT Cypress Home is tight on lots 7 & 10. Verify !!!

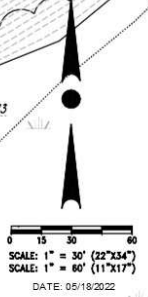

DATE: 05/18/2022